

COPOLYMER POLYPROPYLENE PLASTIC

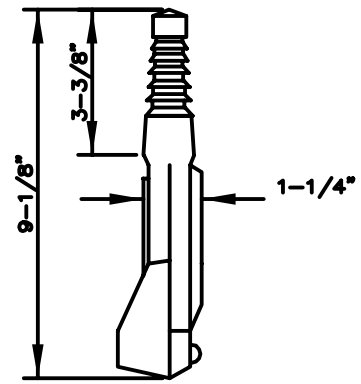

1/2" GRADE 60
REINFORCEMENT

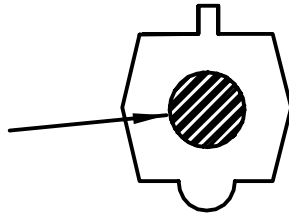

NOTE:
STEPS IN PREFABRICATED MANHOLE SECTIONS MUST BE TIGHT AND FIRMLY EMBEDDED. THEY MUST ALSO MEET THE ASTM TEST FOR WITHSTANDING PULL-OUT. TOP STEP SHALL BE NO GREATER THAN 27" FROM TOP OF CASTING.

MATERIALS:

PLASTIC:

MUST CONFORM WITH ASTM C-478. STEEL REINFORCING BAR MINIMUM 1/2" GRADE 60. MEETING REQUIREMENTS OF ASTM A615 ENCAPSULATED WITH INJECTION MOLDED COPOLYMER POLYPROPYLENE WITH SERRATED SURFACES.

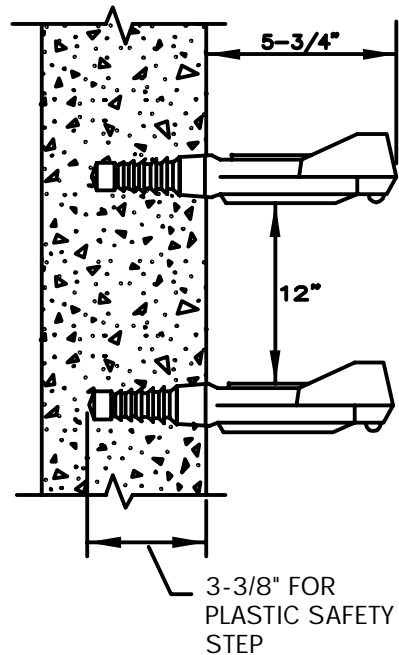

Detail Drawing may not be altered or changed in any manner except by the Public Works Director. It is the responsibility of the user to acquire the most current version.

CITY OF MOLALLA
DEPARTMENT OF PUBLIC WORKS



MANHOLE STEP DETAIL

DRAWN BY	PDG	01/2016
CHECKED BY	JC	01/2016

S-2080